

CONTOUR

LANDSCAPE ARCHITECTURE

PROJECT

Landscape Plan

CLIENT

QIAN

ADDRESS

17 Penshurst Road,
Roselands NSW 1660

BUILDER

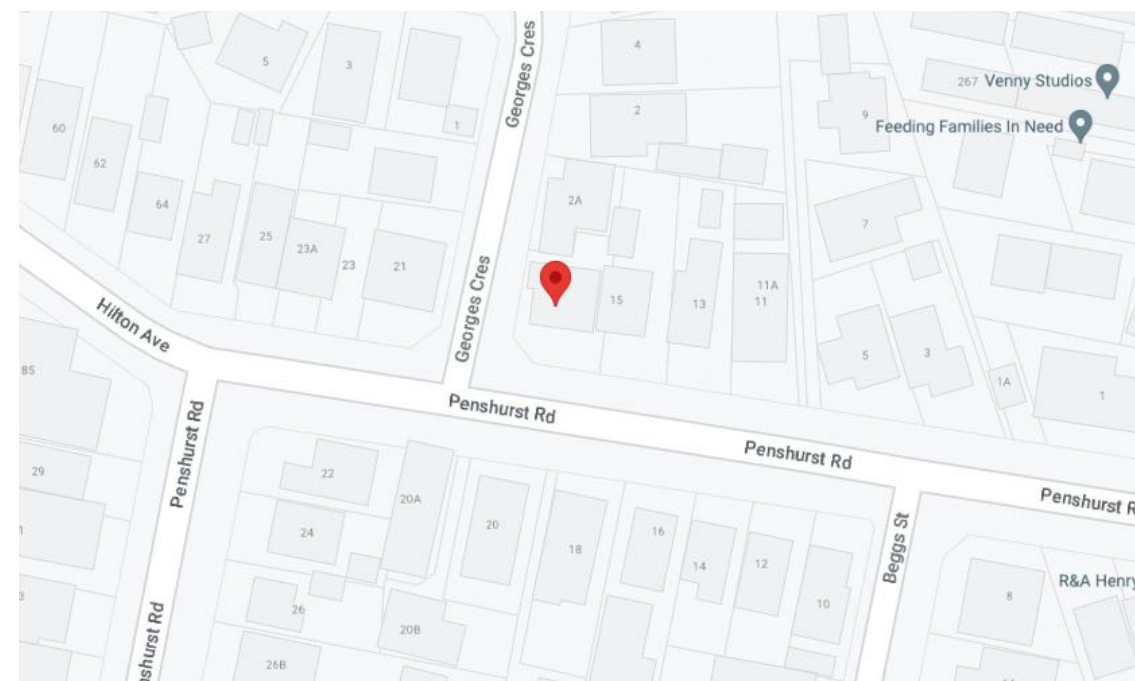
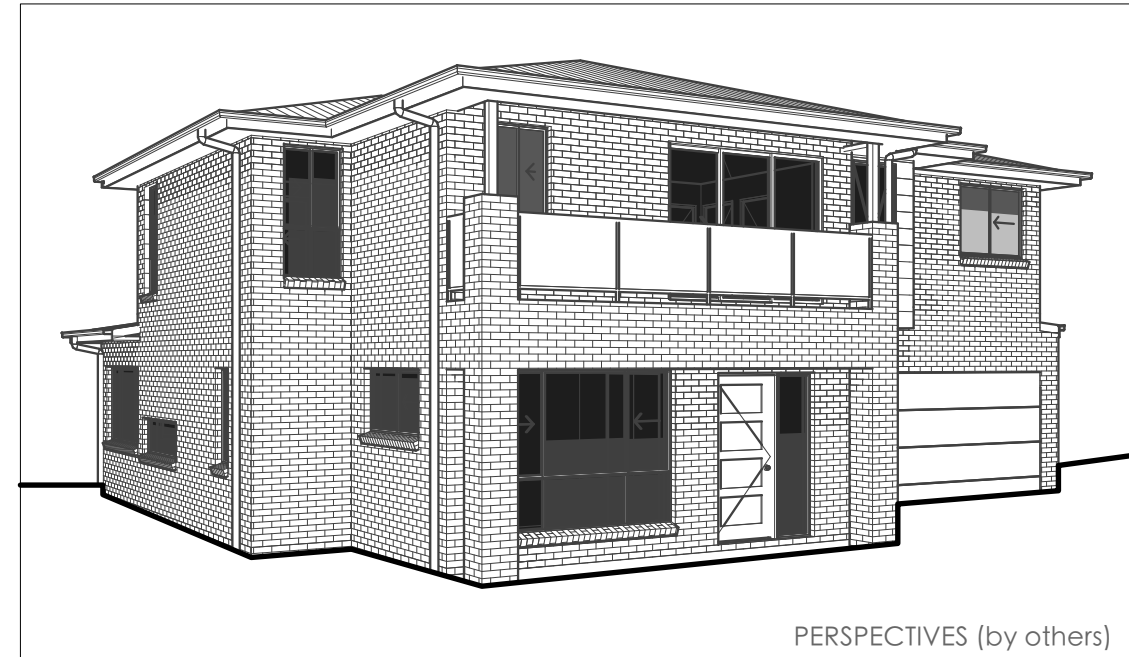

SITE LOCATION
LOT 532 - DP839687

PLANT SCHEDULE				
Botanic Name	Common Name	Quantity	Pot Size	Mature Height
Acmena smithii 'Fire Screen'	Lillypilly	7	300mm	1600
Acmena smithii var. minor	Dwarf Lillypilly	9	300mm	2500
Cupaniopsis anacardioides	Tuckeroo	1	45lt	8000
Elaeocarpus reticulatus	Blueberry Ash	1	100lt	15000
Lomandra 'Tanika'	Dwarf Lomandra	11	140mm	500
Murraya paniculata	Orange Jessamine	7	15lt	2500
Viola hederaceae	Native Violets	7	140mm	300
Westringia 'Jervis Gem'	Coastal Rosemary	8	200mm	1000



LOMANDRA 'TANIKA'



ACMENA SMITHII 'FIRE SCREEN'



ACMENA SMITHII VAR. MINOR



CUPANIOPSIS ANACARDIODES



MURRAYA PANICULATA



ELAEOCARPUS RETICULATUS



VIOLA HEDERACEAE



WESTRINGIA 'JERVIS GEM'

LEGEND

- BOUNDARY LINE
- TREES TO BE RETAINED
- PROPOSED RETAINING WALL
- GARDEN AREA
- LAWN AREAS
- PAVED AREA
- CONCRETE FINISH
- DECORATIVE PEBBLE FINISH (Nepean River Pebble 20mm)

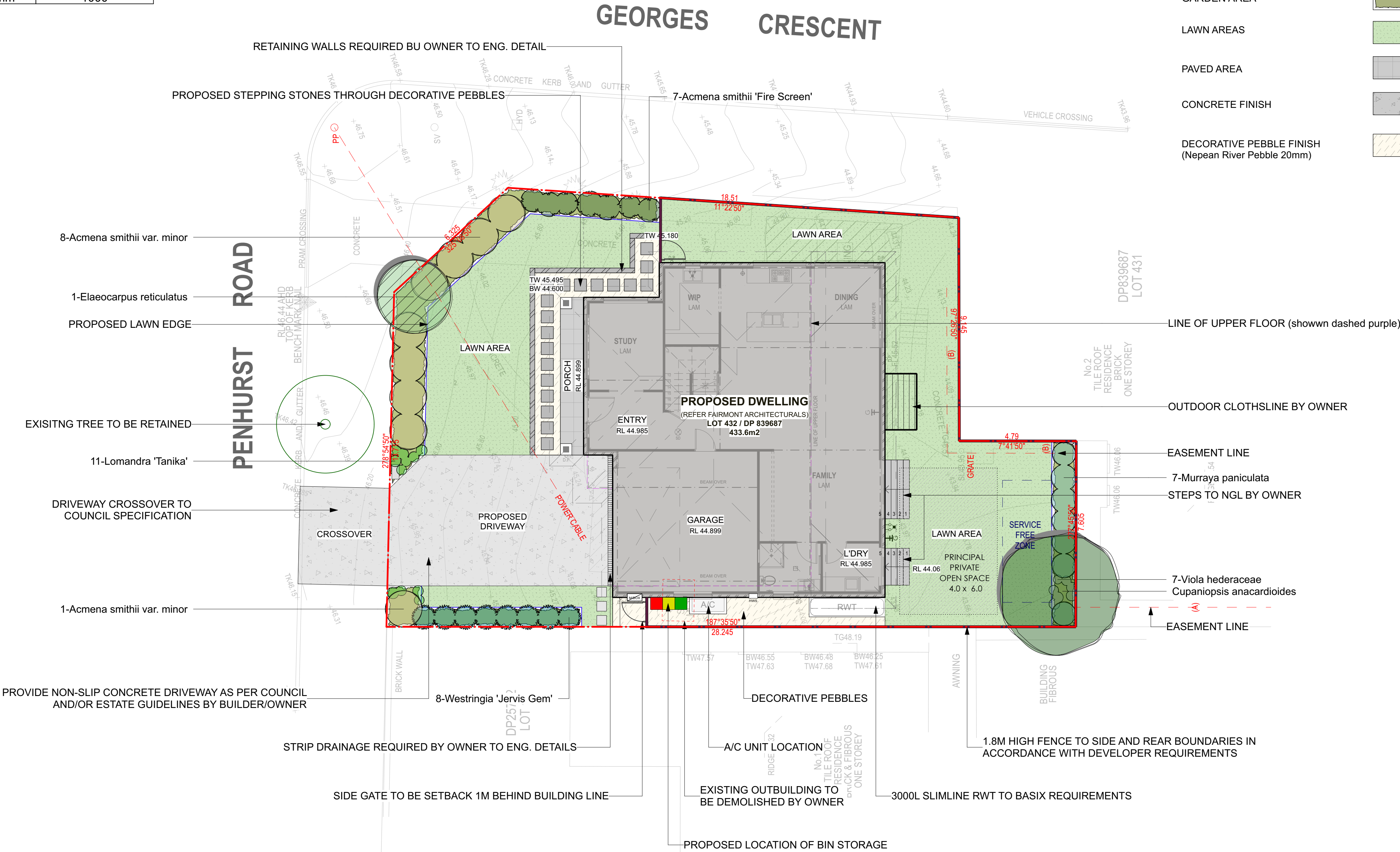

EASEMENTS

- (A) EASEMENT FOR SEWERAGE PURPOSES OVER EXISITNG LINE OF PIPES (APPROX. POSITION) (DP834899)
- (B) PROPOSED EASEMENT FOR OVERHANGING EAVES AND GUTTER 0.5 WIDE. (DOES NOT SEEM TO BE REGISTERED ON THE SUBJECT TITLE)

CONTOUR
LANDSCAPE ARCHITECTURE
PO Box 698 MONA VALE NSW 1660
Tel: 0434 500 705 - AIDLM

PROJECT
QIAN
17 Penshurst Road,
Roselands NSW 1660

NOTES
comply with building code of australia and all relevant australian standards
all works shall be in accordance with development application and construction certificate conditions of consent
all levels to and
refer to survey information relating to existing site data
verify all dimensions prior to works
do not scale from drawings
use figured dimensions in preference to scaling
refer all discrepancies to landscape architect for determination
this drawing is copyright and must not be retained, copied, used or reproduced in any way without prior written permission of
contour landscape architects.

DATE	REV	ISSUE
24/04/23	A	DA

DATE:	24/04/23	DRAWING LANDSCAPE PLAN
SCALE:	1:100 @ A1 1:200 @ A3	DRAWING NO: C1
DRAWN:	BT	REV: A

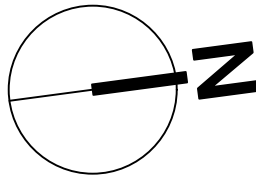

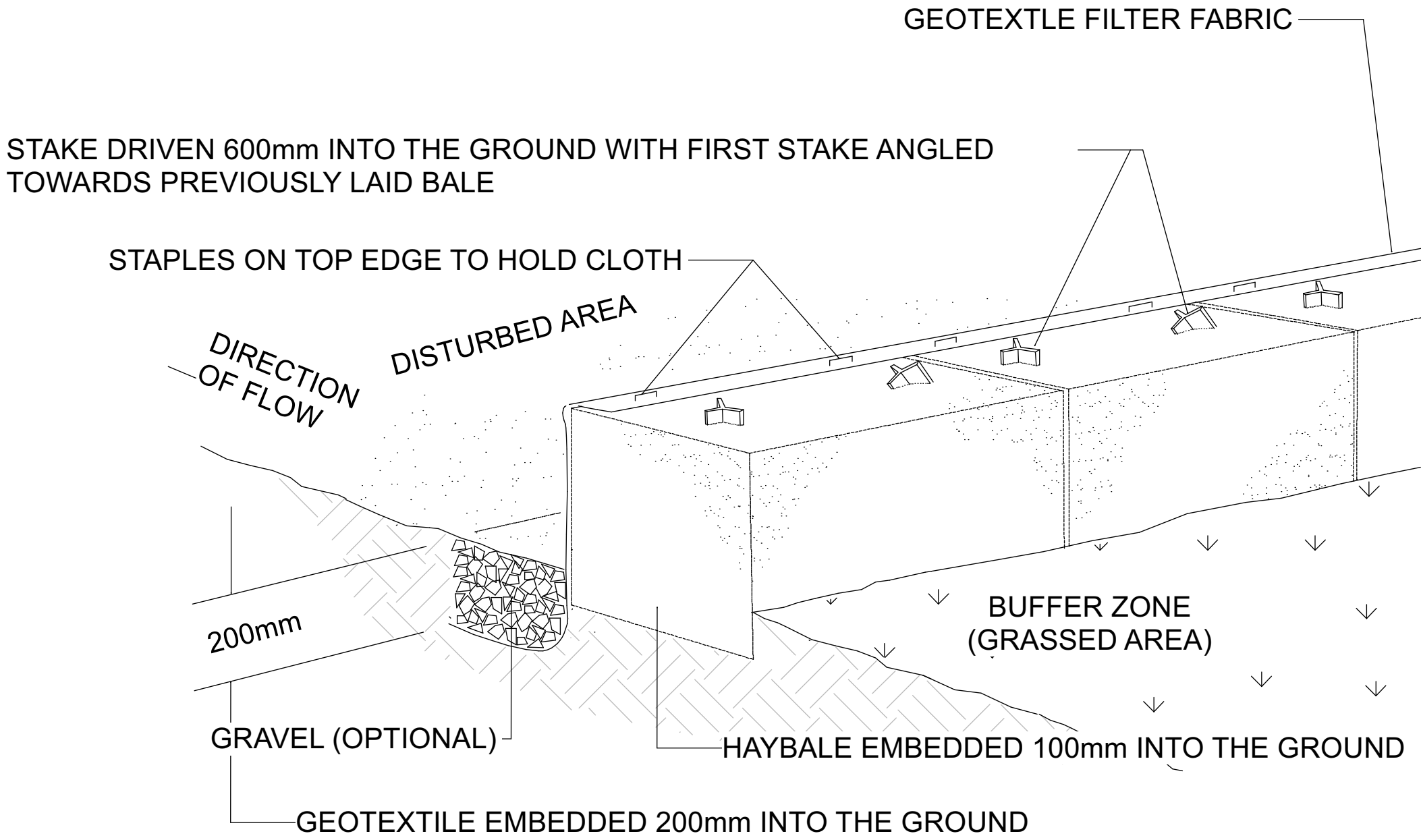

STRAW BALE AND GEOTEXTILE SEDIMENT FILTER

Scale 1:25

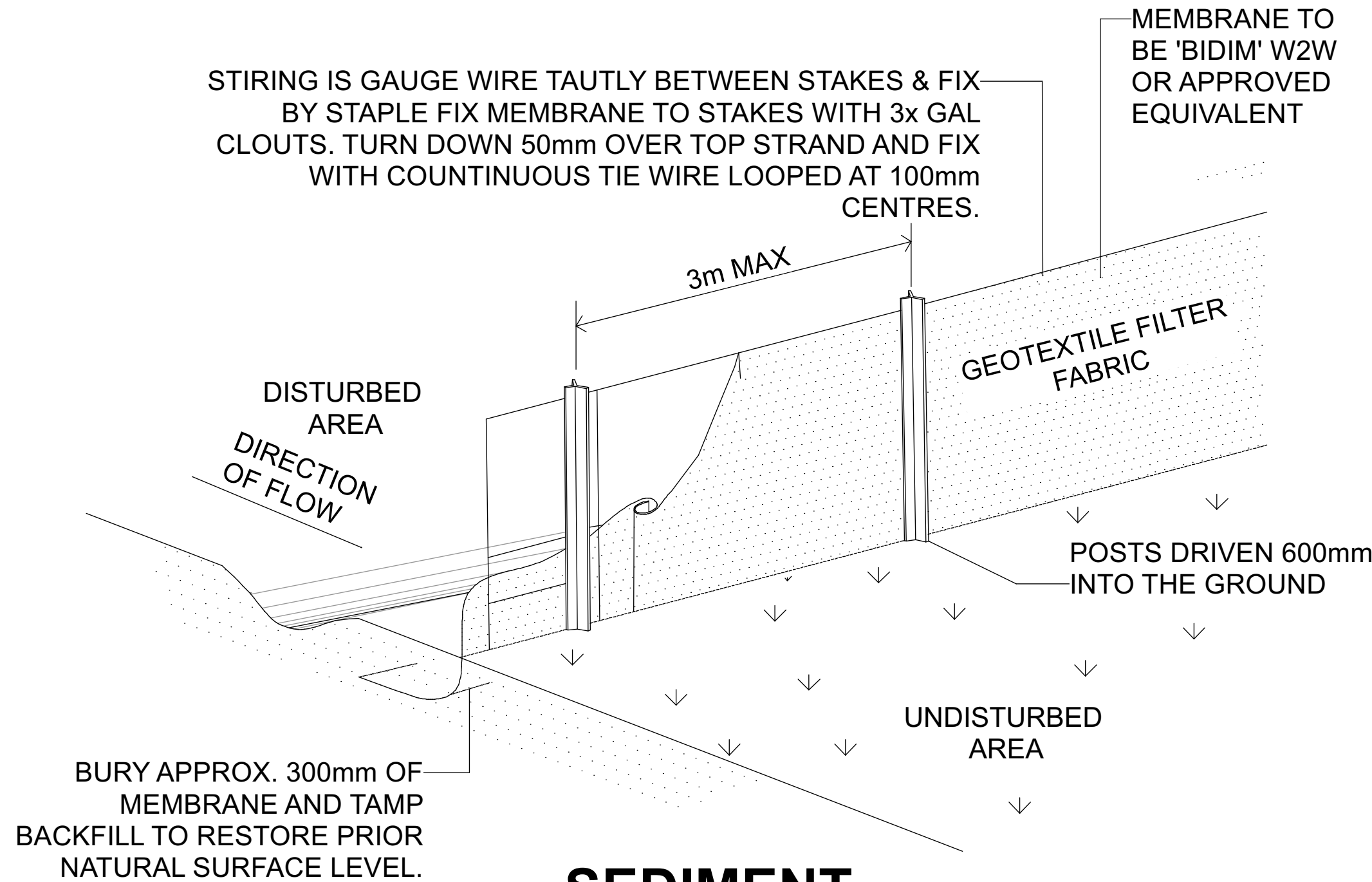

SEDIMENT CONTROL FENCE

Scale 1:25

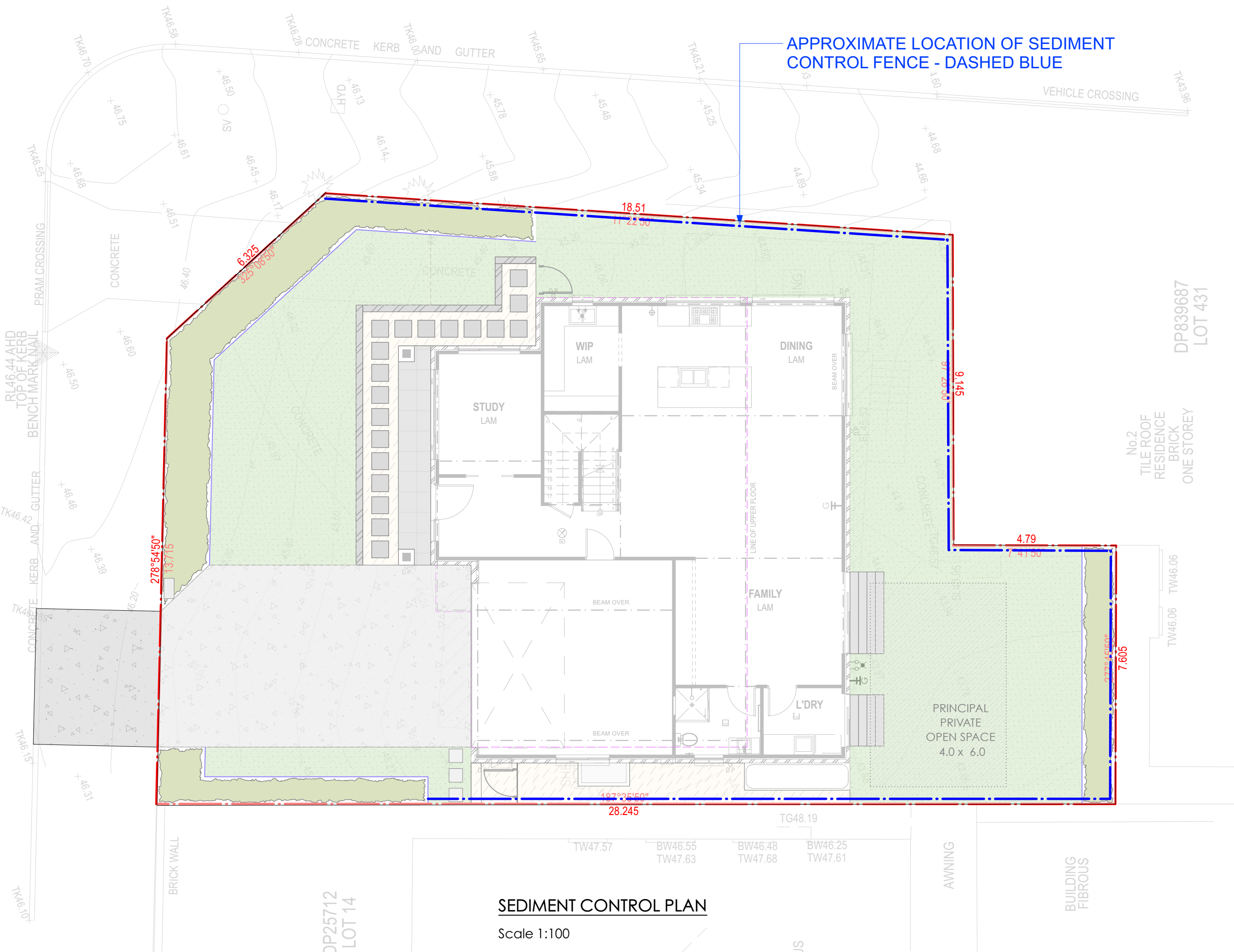

NOTE

1. ALL WORK SHALL BE GENERALLY CARRIED OUT IN ACCORDANCE WITH:
 - A. LOCAL AUTHORITY REQUIREMENTS
 - B. EPA REQUIREMENTS
 - C. NSW DEPARTMENT OF HOUSING MANUAL
2. MAINTAIN THE EROSION CONTROL DEVICES TO THE SATISFACTION OF THE SUPERINTENDENT AND THE LOCAL AUTHORITY.
3. WHEN STORMWATER PITS ARE CONSTRUCTED, PREVENT SITE RUNOFF ENTERING UNLESS SILT FENCES ARE ERECTED AROUND PITS.
4. CONTRACTOR IS TO ENSURE ALL EROSION & SEDIMENTATION CONTROL DEVICES ARE MAINTAINED IN GOOD WORKING ORDER AND OPERATE EFFECTIVELY. REPAIRS AND/OR MAINTENANCE SHALL BE UNDERTAKEN AS REQUIRED, PARTICULARLY FOLLOWING STORM EVENTS.
5. CLEAN BEHIND FENCE EACH MAJOR STORM OR OTHERWISE AS DIRECTED AND REMOVE ALL SILT FROM THE SITE.
6. 'BIDIM' W2W IS SUPPLIED BY GEOFABRICS AUST. P/L

CONTOUR
LANDSCAPE ARCHITECTURE

PO Box 698 MONA VALE NSW 1660
Tel: 0434 500 705 - AIDLM

PROJECT
QIAN

17 Penshurst Road,
Roselands NSW 1660

NOTES

comply with building code of australia and all relevant australian standards
all works shall be in accordance with development application and construction certificate conditions of consent
all levels to and
refer to survey information relating to existing site data
verify all dimensions prior to works
do not scale from drawings
use figured dimensions in preference to scaling
refer all discrepancies to landscape architect for determination
this drawing is copyright and must not be retained, copied, used or reproduced in any way without prior written permission of
contour landscape architects.

DATE	REV.	ISSUE
24/04/23	A	DA

DATE: 24/04/23

SCALE: 1:100 @ A1
1:200 @ A3

DRAWN: BT

DRAWING
**SEDIMENT
CONTROL PLAN**

DRAWING NO:
C2

REV:
A

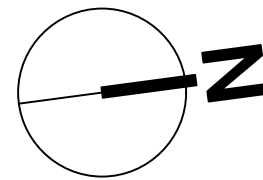

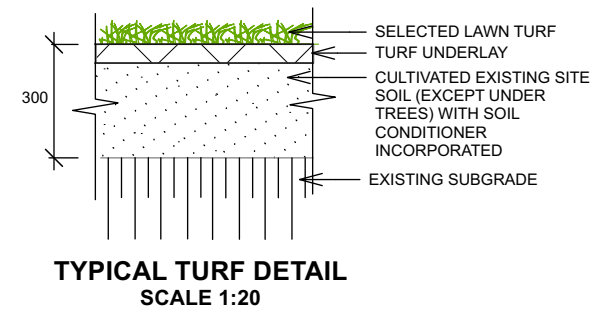
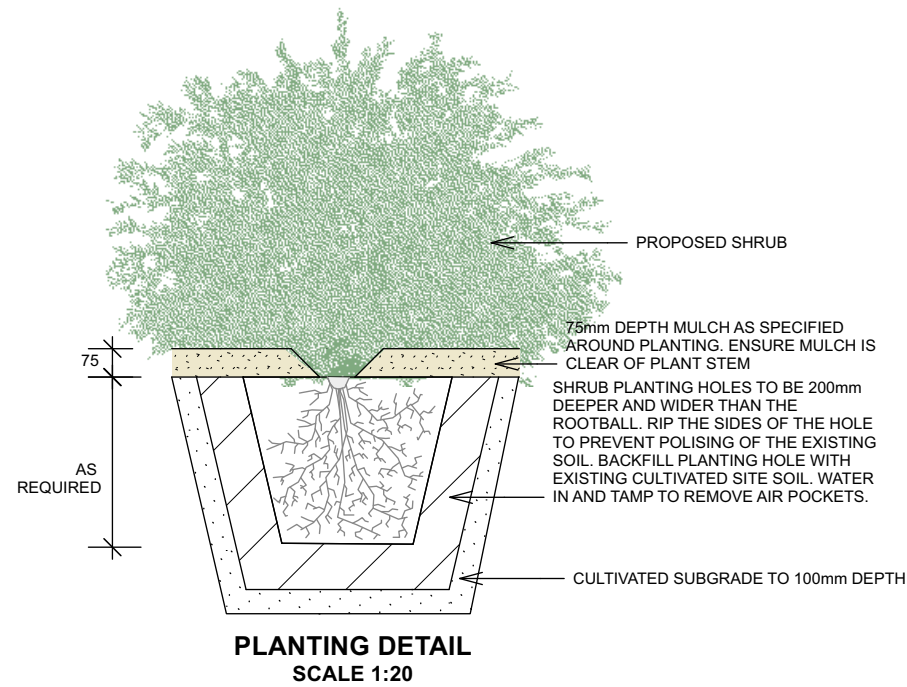
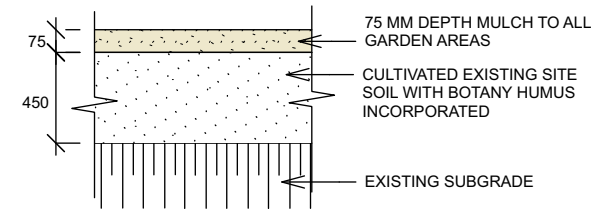
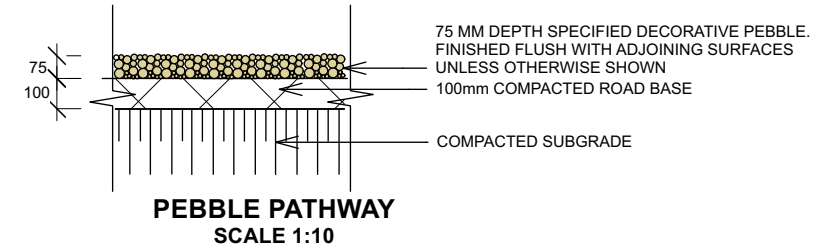
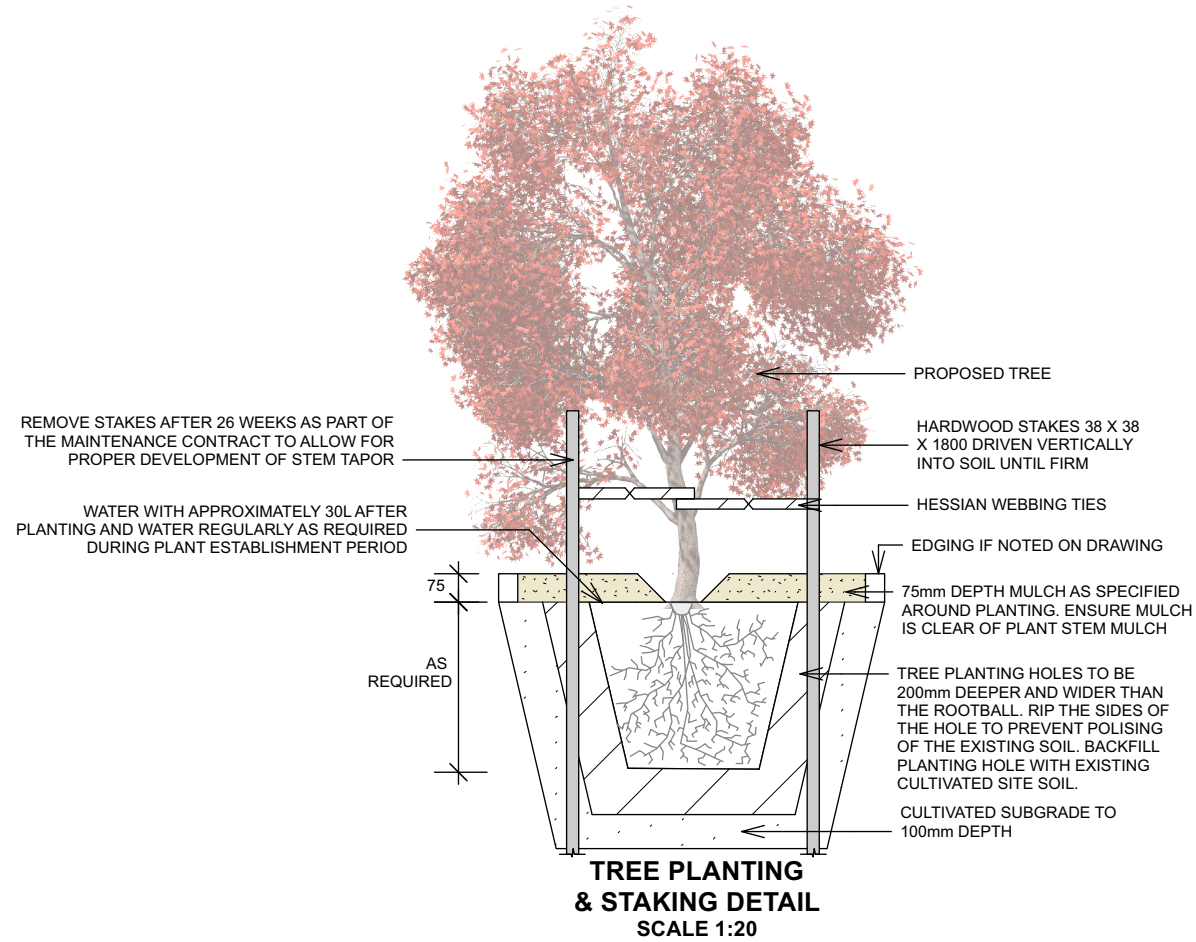

CONTOUR
LANDSCAPE ARCHITECTURE

PO Box 698 MONA VALE NSW 1660
Tel: 0434 500 705 - AIDLM

PROJECT

QIAN

17 Penshurst Road,
Roselands NSW 1660

NOTES

comply with building code of australia and all relevant australian standards
all works shall be in accordance with development application and construction certificate conditions of consent
all levels to ahd
refer to survey information relating to existing site data
verify all dimensions prior to works
do not scale from drawings
use figured dimensions in preference to scaling
refer all discrepancies to landscape architect for determination
this drawing is copyright and must not be retained, copied, used or reproduced in any way without prior written permission of contour landscape architects.

DATE REV. ISSUE

24/04/23 A

DATE: 24/04/23

SCALE: N/A

DRAWN: BT

**DRAWING
PLANTING
DETAILS**

DRAWING NO:
C3

REV:
A

LANDSCAPE SPECIFICATION

ALL LANDSCAPE WORKS SHALL BE EXECUTED BY A COMPETENT LANDSCAPE CONTRACTOR EXPERIENCED IN HORTICULTURAL PRACTICE AND LANDSCAPE CONSTRUCTION. THE CONTRACTOR SHALL HOLD A CURRENT NSW STRUCTURAL LANDSCAPE LICENSE OR BE A MEMBER OF THE NSW LANDSCAPE CONTRACTORS ASSOCIATION. IRRIGATION WORKS SHALL BE EXECUTED BY A CONTRACTOR SUITABLY QUALIFIED AND LICENSED BY THE NSW DEPARTMENT OF FAIR TRADING FOR URBAN IRRIGATION.

THESE GENERAL LANDSCAPE SPECIFICATIONS SHALL BE READ IN CONJUNCTION WITH DETAILED DOCUMENTATION PREPARED BY CONTOUR LANDSCAPE ARCHITECTURE, STRUCTURAL ENGINEERING PLANS, STORMWATER ENGINEER PLANS, ARCHITECTURAL DUCUMENTATION AND ALL D.A. CONSENT CONDITIONS.

LANDSCAPE HARDWORKS DEMOLITION, BULK EARTHWORKS, RETAINING WALLS, STONE FACING, PLANTER BOXES, PAVING, DRAINAGE, WATERPROOFING, FENCING AND ALL SITE CONSTRUCTION INDICATED SHALL BE EXECUTED IN ACCORDANCE WITH LANDSCAPE ARCHITECTURAL, ARCHITECTURAL + ENGINEERING SPECIFICATIONS LANDSCAPE WORKS SHALL GENERALLY BE UNDERTAKEN IN ACCORDANCE WITH DA APPROVED PLANS AND CONSTRUCTION CERTIFICATE PLANS AND DETAILS AND SHALL BE COMPLIANT WITH:

- AS4970-2009 Protection of trees on development sites
- AS 4970-2009/Amdt 1-2010 Protection of trees on development sites
- AS4373-2007 Pruning of amenity trees
- AS4419-2003 Soils for landscaping and garden use
- AS4454-2012 Composts, soil conditioners and mulches
- AS3743-2003 Potting mixes
- AS/NZ3500:2015 Plumbing and drainage Set

SERVICES

BEFORE LANDSCAPE WORK IS COMMENCED THE LANDSCAPE CONTRACTOR IS TO ESTABLISH THE POSITION OF ALL SERVICES LINES AND ENSURE TREE PLANTING IS CARRIED OUT AT LEAST 3 METRES AWAY FROM THESE SERVICES. SERVICES LIDS, VENTS AND HYDRANTS SHALL BE LEFT EXPOSED AND NOTE COVERED BY ANY LANDSCAPE FINISHES (TURNING, PAVING, GARDEN BEDS ETC.) FINISH ADJOINING SURFACES FLUSH WITH PIT LIDS.

MANAGEMENT OF TREE PROTECTION (AS REQUIRED)

A QUALIFIED AND APPROVED ARBORIST IS TO BE CONTRACTED TO UNDERTAKE OR MANAGE THE INSTALLATION OF PROTECTIVE FENCING, AND TO UNDERTAKE SUCH MEASURES AS THEY DEEM APPROPRIATE TO PRESERVE THE SUBJECT TREES TO BE RETAINED. THE ARBORIST IS TO BE RETAINED FOR THE ENTIRE CONTRACT PERIOD TO UNDERTAKE ONGOING MANAGEMENT AND REVIEW OF THE TREES.

CARE SHALL BE TAKEN DURING THE ENTIRE PERIOD OF WORKS TO ENSURE NO DAMAGE TO ROOTS OR CANOPIES OF TREES TO BE RETAINED. NO STORING OF BUILDING MATERIALS, WASHING OF EQUIPMENT, DISPOSAL OF CHEMICALS, ETC. SHALL BE PERMITTED BENEATH CANOPY OF TREES TO BE RETAINED. NO EXCAVATION OR TRENCHING SHOULD OCCUR BENEATH CANOPIES EXCEPT FOR COUNCIL-APPROVED WORKS. ALL EXCAVATION BENEATH TREE CANOPIES SHALL BE UNDERTAKEN TO COUNCIL / PROJECT ARBORIST INSTRUCTIONS. PROJECT ARBORIST SHALL BE ADVISED AND ATTEND SITE IF TREE ROOTS GREATER THAN 50MM DIAMETER ARE ENCOUNTERED.

PREPARATION BY BUILDER

BUILDER SHALL REMOVE ALL EXISTING CONCRETE PATHWAYS, FENCES, FOOTINGS, WALLS, ETC. NOT NOTATED TO BE RETAINED AND COMPLETE ALL NECESSARY EXCAVATION WORK PRIOR TO COMMENCEMENT ON SITE BY LANDSCAPE CONTRACTOR. BUILDER SHALL ALSO INSTALL NEW RETAINING WALLS, KERBS, LAYBACK KERB, CROSSOVER, PATHWAYS, ETC. AND MAKE GOOD ALL EXISTING KERBS, GUTTERS, ETC. AS NECESSARY AND TO APPROVAL OF COUNCIL. BUILDER SHALL ENSURE THAT A MINIMUM 600MM OF TOPSOIL IN GARDEN AREA AND A MINIMUM 150MM OF TOPSOIL IN LAWN AREAS EXISTS. SHOULD REQUIRED DEPTHS NOT EXIST BUILDER SHALL CONTACT LANDSCAPE ARCHITECT AND ASK FOR INSTRUCTIONS PRIOR TO COMPLETION OF EXCAVATION WORKS.

ALL LEVELS AND SURFACE DRAINAGE SHALL BE DETERMINED BY OTHERS AND APPROVED ON SITE BY LANDSCAPE CONTRACTOR.

SOIL PREPARATION + PLANTING SOILS

CULTIVATE TO A DEPTH OF 450MM ALL PROPOSED GARDEN AREAS AND 300mm FOR ALL LAWN AREA. DO NOT CULTIVATE BENEATH EXISTING TREES TO BE RETAINED. IN AREAS WHERE FILL IS REQUIRED GAIN REQUIRED SHAPES AND LEVELS USING A PREMIUM GRADE SOIL MIX. IN AREAS WHERE EXCAVATION IS REQUIRED (IF IN CLAY) OVER EXCAVATE AS REQUIRED TO ALLOW FOR INSTALLATION OF 600MM DEPTH OF PREMIUM GRADE TOPSOIL MIX TO GARDEN AREAS AND 300M DEPTH OF PREMIUM GRADE TOPSOIL MIX TO LAWN AREAS.

SUBGRADE PREPARATION

BEFORE LAYING TOPSOIL, THE FOLLOWING SUBGRADE TREATMENT MUST BE APPLIED TO ALL FINISHED SUBGRADE AREAS:

- 1. FAIR + TRIM TO RELATIVE LEVEL TO ACCOMMODATE REQUIRE OVERALL SOIL DEPTH
- 2.REMOVE ROCK >100mm DIAMETER
- 3. REMOVE RUBBISH SUCH AS CONSTRUCTION GENERATED WASTER, PLASTICS, METALS, GLASS
- 4. APPLY GYPSUM AND LIME AT MANUFACTURER'S RECOMMENDED RATES
- 5. LOOSEN SUBGRADE TO 200mm DEPTH LEAVING SURFACE 'KEYED' TO ACCEPT TOPSOIL

CONTRACTOR SHALL UNDERTAKE PH TESTS AND ADJUST WHERE NECESSARY TO ACHIEVE A PH WITHIN THE 5.5 - 7.5 RANGE. MIX IN GYPSUM AT MANUFACTURER'S RECOMMENDED RATES IF CLAY SOIL ENCOUNTERED.

UNDERTAKE ALL REQUIRED ACTION TO ENSURE THAT NO ROOTBALLS OF PROPOSED PLANTS SIT IN CLAY WELLS AND THAT ALL GARDEN AREAS AND LAWN AREAS DRAIN SATISFACTORILY. NOTE IT IS INTENDED THAT WHEREVER POSSIBLE EXISTING LEVELS SHALL NOT BE ALTERED THROUGH GARDEN AND LAWN AREAS. IT IS THE CONTRACTOR'S RESPONSIBILITY TO ENSURE THAT THE END RESULT OF THE PROJECT IS THAT ALL LAWN AND GARDEN AREAS DRAIN SUFFICIENTLY (BOTH SURFACE AND SUBSTRATE), ARE AT REQUIRED FINISH LEVELS AND HAVE SUFFICIENT SOIL DEPTHS TO ENABLE LAWN AND PLANTS TO THRIVE AND GROW. SHOULD ALTERNATIVE WORKS TO THOSE SPECIFIED REQUIRED TO ACHIEVE THAT RESULT, CONTRACTOR SHALL INFORM BUILDER AT TIME OF TENDER AND REQUEST INSTRUCTIONS.

PLANTING

ALL PLANTS SHALL BE WELL GROWN AND DISEASE FREE. PLANTING SHALL BE IN ACCORDANCE WITH PLANTING SCHEDULE. TREES SHALL BE GROWN TO NATSPEC. GENERAL PLANT MATERIAL (EXOTICS AND ENDEMIC) SUPPLY PLANTS IN ACCORDANCE WITH PLANTING SCHEDULE. NO SUBSTITUTIONS ARE PERMITTED WITHOUT THE CONSENT OF THE SUPERVISING LANDSCAPE ARCHITECT. PLANT MATERIAL SHALL BE GROWN TO NATSPEC AND SHALL BE VIGOROUS, WELL ESTABLISHED, FREE OF DISEASE AND PESTS, HARDENED OFF, TRUE TO FORM, AND GROWN IN THEIR FINAL CONTAINERS FOR NOT LESS THAN 12 WEEKS. TREES SHALL HAVE A SINGLE LEADING SHOOT AND POTS FREE FROM WEEDS.

IMMEDIATELY REJECT DRIED OUT, DAMAGED OR UNHEALTHY PLANT MATERIAL BEFORE PLANTING.

PLANT HOLES SHALL BE DUG APPROXIMATELY TWICE THE WIDTH AND TO 100MM DEEPER THAN PLANT ROOTBALLS THAT THEY ARE TO RECEIVE. BASE AND SIDES OF HOLE SHALL BE FURTHER LOOSENEED. FERTILISER, FOLLOWED BY 100MM DEPTH OF TOPSOIL MIX SHALL THEN BE PLACED INTO BASE OF HOLE AND LIGHTLY CONSOLIDATED. BASE OF HOLE SHALL THEN BE WATERED. REMOVE PLANT CONTAINER AND INSTALL PLANT INTO HOLE. ROOTBALL SHALL BE BACKFILLED WITH SURROUNDING TOPSOIL AND TOPSOIL FIRMED INTO PLACE. AN APPROVED SHALLOW DISH SHALL BE FORCED TO CONTAIN WATER AROUND BASE OF STEM. BASE OF STEM OF PLANT SHALL FINISH FLUSH WITH FINISHED SOIL LEVEL. ONCE INSTALLED PLANT SHALL BE THOROUGHLY WATERED AND MAINTAINED FOR THE DURATION OF THE CONTRACT.

STAKES + TIES

THE LANDSCAPE CONTRACTOR SHALL REPLACE OR ADJUST PLANT STAKES, AND TREE GUARDS AS NECESSARY OR AS DIRECTED BY THE LANDSCAPE ARCHITECT.

STAKES SHALL BE STRAIGHT HARDWOOD, FREE FROM KNOTS AND TWISTS, POINTED AT ONE END AND SIZED ACCORDING TO THE SIZE OF PLANTS TO BE STAKED:

- 1. 5-15 LITRE SIZE PLANT 1X 1200 X 25 X 25MM
- 2. 35-75 LITRE SIZE PLANT 2X 1500 X 38 X 38MM
- 3. 100+ LITRE SIZE PLANT 3X 1800 X 50 X 50MM

TIES SHALL BE 50MM WIDE HESSIAN WEBBING OR APPROVED EQUIVALENT NAILED OR STAPLED TO STAKE. DRIVE STAKES A MINIMUM ONE THIRD OF THEIR LENGTH, AVOIDING DAMAGE TO THE ROOT SYSTEM, ON THE WINDWARD SIDE OF THE PLANT.

FERTILIZER

AT PLANTING SPREAD SLOW RELEASE FERTILIZER AROUND DRIP LINE OF ALL PLANTS AT MANUFACTURER'S RECOMMENDED RATES

GENERAL APPLICATION:

EQUAL TO OSMOCOTE PLUS TRACE ELEMENTS - ALL PURPOSE NPK 19.4 : 1.6 : 6

NATIVE PLANTS: EQUAL TO OSMOCOTE PLUS TRACE ELEMENTS - NATIVE GARDENS NPK 17.9 : 0.8 : 7.3

COMPOST

SHALL BE WELL-ROTTED BEGETATIVE MATTER OR ANIMAL MANURE, OR OTHER APPROVED MATERIAL, FREE FROM HARMFUL CHEMICALS, GRASS AND WEEK GROWTH AND WITH NEUTRAL PH. PROVIDE A CERTIFICATE OF PROOF OF PH UPON REQUEST.

MULCH

ENSURE ALL MULCH IS FREE OF WEED SEED AND VEGETATIVE MATERIAL. PROVIDE SAMPLE OF MULCH FOR CLIENT APPROVAL PRIOR TO DELIVERY.

PLACE MULCH TO REQUIRED DEPTH. (REFER TO DRAWINGS) CLEAR OF PLANT STEMS, AND RAKE TO AN EVEN SURFACE FINISHING 25MM BELOW ADJOINING LEVELS. ENSURE MULCH IS WATERED IN AND TAMPED DOWN DURING INSTALLATION.

EDGING

EDGING SHALL BE INSTALLED AT THE JUNCTION OF LAWN AND GARDEN AREAS AS INDICATED ON DRAWINGS (REFER TO DETAIL) . EDGE SHALL BE FINISHED LEVEL WITH LAWN OR ADJOINING GRAVEL. EDGE

LAWN

TURF SHALL BE 'SIR WALTER' BUFFALO. TURF ROLLS SHALL BE A MINIMUM OF 25mm THICK SUPPLIED FROM A SPECIALIST GROWER OF CULTIVATED TURF. IT SHALL BE OF EVEN THICKNESS, FREE FROM WEEDS. TURF SHALL BE DELIVERED WITHIN 24HRS OF CUTTING AND LAID WITHIN 24 HRS OF DELIVERY. CONTRACTOR SHALL LAY CLOSE BUTTED IN STRETCHER PATTERN WITH STAGGERED JOINTS TO FINISH FLUSH WITH ADJOINING SURFACES AFTER TAMPING. LIGHTLY TAMP TO AN EVEN SURFACE IMMEDIATELY AFTER LAYING. DO NOT USE ROLLER. ENSURE TURF ROLLS ARE NOT ALLOWED TO DRY OUT AND WATER IMMEDIATELY AFTER LAYING AS NECESSARY TO ENSURE TOPSOIL IS KEPT MOIST TO 100mm DEPTH. PROTECT NEWLY LAID TURF FROM PEDESTRIAN AND VEHICULAR TRAFFIC UNTIL ESTABLISHED. FERTILISE WITHIN 2 WEEKS OF LAYING WITH AN APPROVED LAWN FERTILISER APPLIED TO MANUFACTURER'S RECOMMENDATIONS. APPLY ADDITIONAL FERTILISER AS REQUIRED TO MAINTAIN HEALTHY GROWTH. ONCE ESTABLISHED, MOW TO MAINTAIN GRASS HEIGHT BETWEEN 30-50mm.

AT SAME TIME MAKE GOOD ALL EXISTING LAWN AREAS USING SAME LAWN TYPE. LAWNS IN SHADE SHALL BE OVERSOWN WITH AN APPROVED SEED MIX. ALLOW TO RETRIM AND RETURF COUNCIL NATURE STRIP AS REQUIRED.

FENCING

(REFER TO DRAWINGS)

PAVING & CONCRETE WORKS

AREAS TO BE PAVED SHALL BE EXCAVATED OR FILLED TO ALLOW FOR INSTALLATION OF BEDDING MATERIALS. LEVELS AND FALLS SHALL BE AS PER PLAN. SURFACE DRAINAGE ON PAVING SHALL BE TOWARDS GRATED DRAINS INSTALLED BY BUILDER WITH ALL DRAINS CONNECTED TO STORMWATER SYSTEM.

IRRIGATION

(REFER TO DRAWINGS)

CONTOUR
LANDSCAPE ARCHITECTURE

PO Box 698 MONA VALE NSW 1660
Tel: 0434 500 705 - AIDLM

PROJECT

QIAN

17 Penshurst Road,
Roselands NSW 1660

NOTES

comply with building code of australia and all relevant australian standards
all works shall be in accordance with development application and construction certificate conditions of consent
all levels to ahd
refer to survey information relating to existing site data
verify all dimensions prior to works
do not scale from drawings
use figured dimensions in preference to scaling
refer all discrepancies to landscape architect for determination
this drawing is copyright and must not be retained, copied, used or reproduced in any way without prior written permission of
contour landscape architects.

DATE REV. ISSUE

24/04/23 A

DATE: 24/04/23

SCALE: N/A

DRAWN: BT

DRAWING
PLANTING
SPECIFICATION

DRAWING NO:
C4

REV:
A